



Coast-to-Coast  
Trail

# Your Guide to NParks Coast-to-Coast Trail



**nparksbuzz**

Share your love for nature with us at  
**#nparksbuzz**

# NParks Coast-to-Coast Trail

Hi there! I am Phil, a leaf from the native Broad-leaved Sterculia (*Sterculia macrophylla*).

Join me as I guide you through a curated walking experience along the Coast-to-Coast Trail, a 36 km route that spans across Singapore stretching from Jurong Lake Gardens in the west to Coney Island Park in the northeast.

Choose to explore the Trail on your own using this Trail guide or download the Coast-to-Coast Trail mobile app for a more immersive experience to discover parks, park connectors, nature areas, places of interest and local flora and fauna.

Visit the 10 checkpoints demarcated with checkpoint markers like the one on the right. Scan the animal characters on them with the Augmented Reality setting in the app and watch them come to life on your phone! My furry and feathered friends will not only share nuggets of information on themselves, but also on the area around them.

From logging in to the app, to checking in at any of the 10 checkpoints, completing quests, sharing your experiences in the app and on social media, or finding "hidden fruits", there is a wealth of opportunities to earn rewards points! Your hard-earned points can be converted into exciting rewards from our tenants and partners!

To download the app and for more information on the Coast-to-Coast Trail, visit [www.nparks.gov.sg/c2c](http://www.nparks.gov.sg/c2c).



# NParks Coast-to-Coast Trail



## Legend

CHECKPOINT (CP)

COAST-TO-COAST TRAIL



# Points of Interest around Checkpoint 1 Jurong Lake Gardens



**Neram Streams**  
(Open from late Apr 2019)

A series of streams channel stormwater runoff from the surroundings into Jurong Lake.



**Rasau Walk**  
(Open from late Apr 2019)

A meandering boardwalk that will take you along the water's edge, providing opportunities to get close to the lake.



**Gardenhouse**  
(Open from late Apr 2019)

Drop by to find out more about the latest events taking place at the Gardens, or sit back and have a coffee.



**Forest Ramble**  
(Open from late Apr 2019)

A nature-themed play area that comprises varied adventure play experiences for children to mimic the actions of animals.



**PassionWaVe**  
(Open from late Apr 2019)

Enjoy the water scenery by kayak, or participate in dragon-boating here.



**Clusia Cove - Water Play**  
(Open from late Apr 2019)

A series of interconnected tidal pools for families to splash around - rest stop with F&B options included - that offers panoramic views of the Gardens.



## N Parks Coast-to-Coast Trail

### Points of Interest around Checkpoint 2 Bukit Batok Nature Park



#### Quarry Pool

A scenic spot that many have found respite in. An image of tranquility will come to mind immediately when you are there.



#### World War II Memorial Site

A plaque to commemorate the 50th anniversary of the end of WWII lies at the foot of the site. The Lorong Sesuai area was selected by the Japanese during WWII as a memorial site for the soldiers who died.

### Points of Interest around Checkpoint 3 Hindhede Drive



#### Bukit Timah Park Connector Bukit Timah Nature Reserve

(Opening hours: 7 am – 7 pm daily)

Follow trails embedded within the Reserve, an ASEAN Heritage Park and one of the few primary rainforest areas in the country, or learn about the Reserve's treasure trove of native biodiversity at the Visitor Centre.

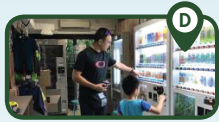

#### Bukit Timah Nature Reserve Campers' Corner

A fully-automated store that equips hikers and nature lovers with the necessities for a journey into the Reserve.



Legend		



# Points of Interest around Checkpoint 4 Adam Road



**Adam Road Food Centre**

It may be small in size, but it's big on food, housing some reputable stalls. Favourites include the famous *nasi lemak*, prawn noodles, Indian *rajak*, *mee rebus*, *mee solo* and mutton soup.



**Singapore Botanic Gardens**

Established in 1859, the Singapore Botanic Gardens is the oldest garden in Singapore, and the only tropical garden to be honoured as a UNESCO World Heritage Site. Besides being an ornamental and recreational garden, it is also scientifically important.



from CP 3

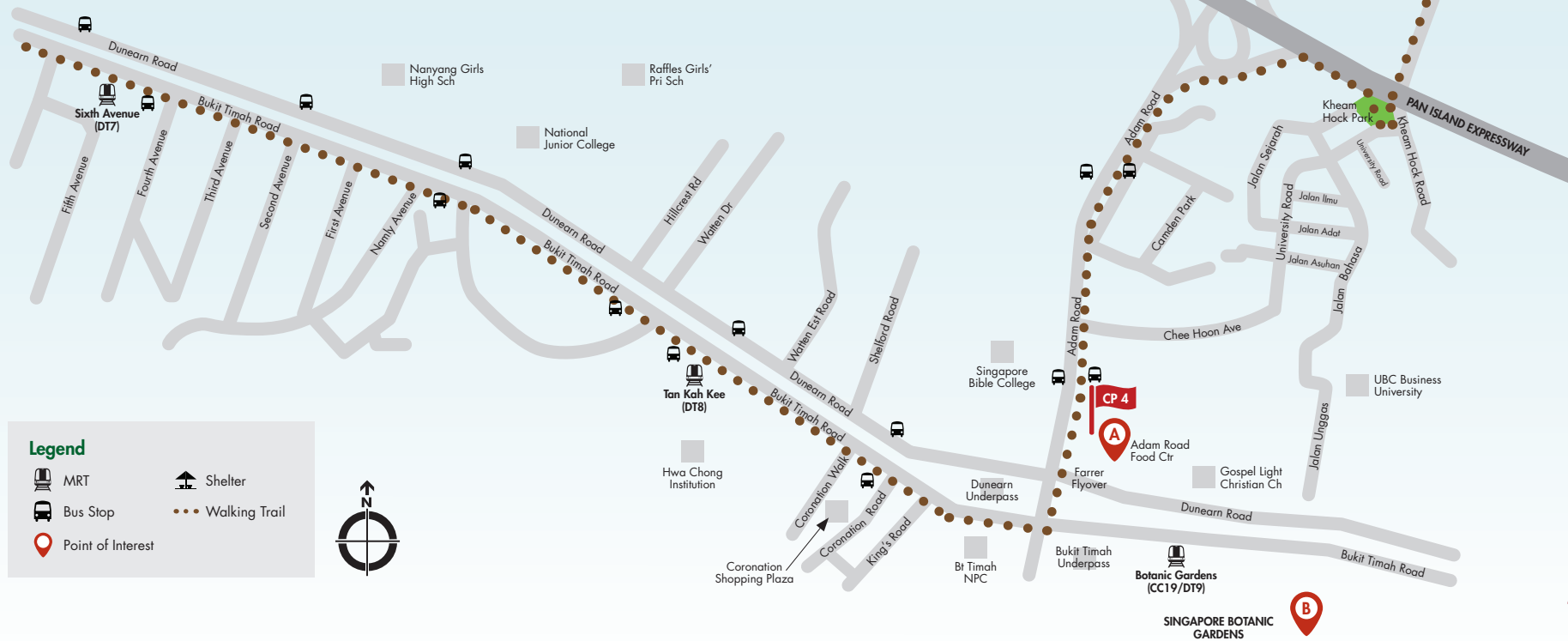

**Legend**

- MRT
- Bus Stop
- Point of Interest
- Shelter
- Walking Trail



# Points of Interest around Checkpoint 4 Singapore Botanic Gardens



## Bukit Timah Gate (Opening hours: 5 am – 12 am daily)

Access to the Singapore Botanic Gardens is extremely convenient with the extension of the Mass Rapid Transit (MRT) system's Circle Line (CCL) and Downtown Line (DTL) - literally next door to the Bukit Timah Gate. Some favourite elements include:

- A** JUJU
- B** Jacob Ballas Children's Garden
- C** Food For Tots
- D** Eco-Garden and Eco-Lake
- E** Ethnobotany Garden
- F** Foliage Garden
- G** Bee's Knees & Botanico at The Garage



## Tyersall Gate (Opening hours: 5 am – 12 am daily)

The "Our Rainforest Heritage" mural at the Tyersall Gate Visitor Centre was designed by artist Eng Siak Loy who designed the Singapore Botanic Gardens stamp series as well as the Tanglin Gate. Some favourite elements include:

- N** National Orchid Garden
- O** Gardens Shop @ National Orchid Garden
- P** The Halia
- Q** The Learning Forest



## Nassim Gate (Opening hours: 5 am – 12 am daily)

The Nassim Gate Visitor Centre showcases the best of Southeast Asian architecture and provides a welcome retreat for visitors after a long walk. Some favourite elements include:

- H** Evolution Garden
- I** Cluny Food Hall
- J** Gardens Shop @ Nassim Gate
- K** Corner House
- L** Casa Verde
- M** Symphony Lake and Palm Valley



## Tanglin Gate (Opening hours: 5 am – 12 am daily)

Entering the Main Gate (also known as Tanglin Gate), visitors will come upon the oldest part of the Gardens, established here at Tanglin in 1859. Some favourite elements include:

- R** Bandstand
- S** Swan Lake
- T** SBG Heritage Museum
- U** Gardens Shop @ Tanglin Gate
- V** CDL Green Gallery
- W** Fusion Spoon

### Legend

- MRT
- Bus Stop
- Services
- F&B/Restaurant
- Restrooms
- Point of Interest
- Shelter
- Walking Trail



# Points of Interest around Marymount Road



### Macritchie Reservoir Park

A popular spot for nature lovers and exercise enthusiasts, this park is a gateway to Singapore's nature reserves. It borders Singapore's first reservoir and the Central Catchment Nature Reserve.

**Legend**

MRT	F&B/Restaurant	Shelter
Bus Stop	Restrooms	Walking Trail
Point of Interest		





# Points of Interest around Checkpoint 5 Bishan-Ang Mo Kio Park



As one of the largest urban parks in central Singapore, Bishan-Ang Mo Kio Park is a great place for families to have a fun day out. Under PUB's Active, Beautiful and Clean Waters (ABC) Programme, the old concrete canal has been greened to become a beautiful and verdant 3 km meandering river with lush banks.

Aside from its unique waterways, the park features lush greenery at Pond Gardens and River Plains, making it a popular choice among nearby residents for recreational activities. Some favourite elements include:

- A Lotus Garden
- B Allotment Garden
- C Cleansing Biotope
- D GRUB
- E Therapeutic Garden
- CP 5 Checkpoint 5 Water Playground
- F Bishan-Bidadari Nature Way
- G Inclusive Playground
- H Canopy Garden Dining
- I Toriyard
- J Aramsa – The Garden Spa
- K McDonald's and McCafé
- L Butterfly Habitat
- M Recycle Hill
- N Kallang River @ Bishan-Ang Mo Kio Park
- O Community/Herb Garden
- P Dragonfly Pond



## Points of Interest around Ang Mo Kio Town Garden West



Built on a hillock with lush and spreading greenery, Ang Mo Kio Town Garden West is a great place for nature lovers and fitness enthusiasts alike.

Recreational runners looking for a challenge can jog on the many footpaths winding through the forest and flowing over the hilly terrain. Nature lovers can enjoy the secondary forest which has plants such as Dillenia and Vitex growing plentifully.

- Q Ang Mo Kio Park Connector – Ang Mo Kio Town Centre
- R McDonald's and McCafé
- S Adventure Playground
- T Lotus Pond
- U Allotment Garden
- V Kebun Baru Bird Corner



## N Parks Coast-to-Coast Trail

### Points of Interest around Checkpoint 6 Luxus Hills Park



#### Luxus Hills Park

Nestled in the northeastern region of Singapore, Luxus Hills Park sits on what was originally part of Seletar Hills rubber estates, developed in the late 19th century. Today, as an ode to its history, the terrain here has been reshaped into undulating knolls with winding eco footpaths that enhance the greenery and tranquility within the Seletar Hills estates.

### Points of Interest around Checkpoint 7 Sengkang Floating Wetland



#### Punggol Park Connector Sengkang Floating Wetland

The floating wetland helps improve the water quality, provides a natural habitat for birds and fish, and acts as a seamless connection between the Anchorvale Community Club, Sengkang Sports Complex and Sengkang Riverside Park.



#### Sengkang Riverside Park O' My Kampong

O' My Kampong is an alfresco eatery serving a blend of local delights as well as fusion food to cater to both the young and old.



#### Sengkang Riverside Park Soaring Vision Sculpture

This abstract sculpture depicts the progress and aspirations of our nation. Its components symbolise the spiralling development of people working together for a common cause.



#### Sengkang Riverside Park Skool4Kidz Campus @ Sengkang Riverside Park

The two-storey Skool4kidz Campus @ Sengkang Riverside Park is Singapore's first large childcare centre in a park which has learning spaces that are integrated with nature.

#### Legend

- MRT
- Bus Stop
- Services
- F&B/Restaurant
- Restrooms
- Point of Interest
- Shelter
- Walking Trail



## Points of Interest around Checkpoint 8 Punggol Waterway Park



A

### Jewel Bridge

Inspired by a jewel atop a ring, the Jewel Bridge oversees the western end of Punggol Waterway, where visitors can enjoy views against the evening sky and admire the setting sun along Punggol Reservoir.



B

### Adventure Bridge

Designed to resemble a wooden suspension bridge, this steel bridge provides visitors with great views of the park scenery and waterway.



C

### Look-Out Pavilion

Drop by the Look-Out Pavilion for scenic views of Punggol Waterway and the Watersports Promenade.



D

### Kelong Bridge

Uniquely designed to resemble a *kelong* - an offshore fishing platform built on wooden stilts for fishermen - this bridge reflects the history of Punggol, once a site for several fishing villages.



E

### Biodiversity Wall

This wall features information about the biodiversity you can find along the waterway, such as a diverse range of birdlife due to the waterway's variety of food sources.



F

### Old Punggol Road Bus Stop

Be reminded of the past as you take a nostalgic photo at this bus stop. A bus stop of this design can hardly be seen elsewhere in Singapore.

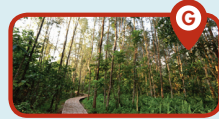

G

### Casuarina Boardwalk

(Opening hours: 7 am - 7 pm daily)

Take in the scenic view and observe rare coastal plants at the Estuary as you stroll on the Boardwalk, made from timber from uprooted Casuarina trees.

### Legend

- MRT
- Bus Stop
- Point of Interest
- F&B/Restaurant
- Restrooms
- Shelter
- Walking Trail



# Points of Interest around Checkpoint 10 Lower Seletar Reservoir Park (Rower's Bay)



**Round Island Route (RIR)  
Heritage Tree Point of Interest  
*Swietenia macrophylla***

At the rest stop near Seletar Aerospace, visitors can learn more about a cluster of three Heritage Trees as they have a rest at the shelter. They can also venture into The Oval at Seletar Aerospace Park to explore the rich colonial history of the area and enjoy the F&B offerings.

The three Broad-leaved Mahogany (*Swietenia macrophylla*) Heritage Trees could have been planted in the 1930s, around the time of the development of the Royal Air Force's Seletar station, and so they are estimated to be around 80 to 90 years old. A native of tropical Central and South America, ranging from Mexico to Brazil, this tree was introduced to Singapore in 1876 from Honduras.



**Lower Seletar Reservoir Park  
(Rower's Bay)**

A short linear stretch of park connector along Seletar Club Road with the Seletar Aerospace park in its vicinity, Rower's Bay is a great place to watch small planes fly by.



Start your  
C2C journey today!  
Scan to download  
the C2C app.

